

### DIMENSION TABLE

DN	A (NOM)	R (NOM)	OD (NOM)	Dr Min	Dr Max	Dm Min	Dm Max	SC	SP	Length (L)
100	90	450	114	113.5	113.8	114.8	115.1	100	100	636
100	45	450	114	113.5	113.8	114.8	115.1	100	100	344
100	30	450	114	113.5	113.8	114.8	115.1	100	100	233
100	22.5	450	114	113.5	113.8	114.8	115.1	100	100	176
100	15	450	114	113.5	113.8	114.8	115.1	100	100	117
100	11.25	450	114	113.5	113.8	114.8	115.1	100	100	88
100	90	600	114	113.5	113.8	114.8	115.1	100	100	849
100	45	600	114	113.5	113.8	114.8	115.1	100	100	459
100	30	600	114	113.5	113.8	114.8	115.1	100	100	311
100	22.5	600	114	113.5	113.8	114.8	115.1	100	100	234
100	15	600	114	113.5	113.8	114.8	115.1	100	100	157
100	11.25	600	114	113.5	113.8	114.8	115.1	100	100	118
100	90	1200	114	113.5	113.8	114.8	115.1	100	100	1697
100	45	1200	114	113.5	113.8	114.8	115.1	100	100	918
100	30	1200	114	113.5	113.8	114.8	115.1	100	100	621
100	22.5	1200	114	113.5	113.8	114.8	115.1	100	100	468
100	15	1200	114	113.5	113.8	114.8	115.1	100	100	313
100	11.25	1200	114	113.5	113.8	114.8	115.1	100	100	235
100	90	1830	114	113.5	113.8	114.8	115.1	100	100	2588
100	45	1830	114	113.5	113.8	114.8	115.1	100	100	1401
100	30	1830	114	113.5	113.8	114.8	115.1	100	100	947
100	22.5	1830	114	113.5	113.8	114.8	115.1	100	100	714
100	15	1830	114	113.5	113.8	114.8	115.1	100	100	478
100	11.25	1830	114	113.5	113.8	114.8	115.1	100	100	359

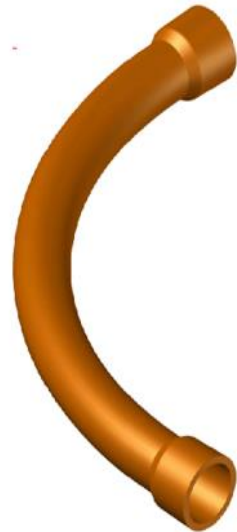
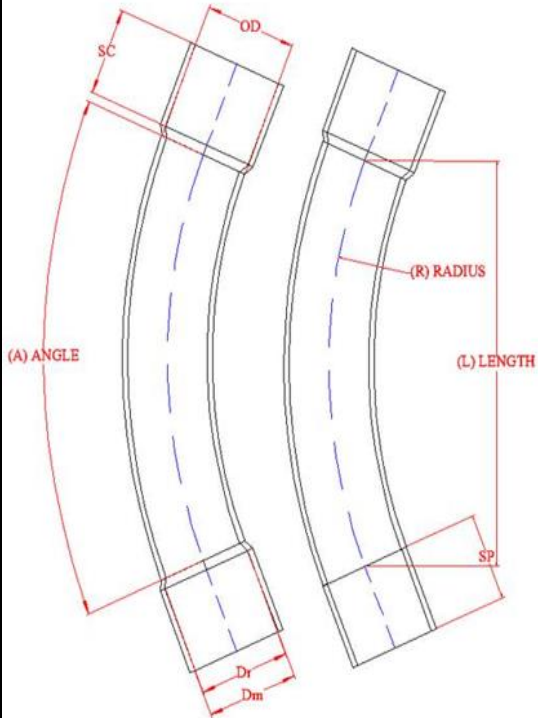

#### Note

- All drawings, dimension, weights and volume are approximate only if critical please contact us
- Nominal size refers to the outside diameter 20-63 whereas greater than 80 refers to internal dimensions
- Sizes in red indicate multi-part bend
- Telstra and NBN conduit and fittings dimensions refer to AS/NZS 1477:2017 PVC pipes and fittings for pressure applications
- SP refers to spigot end
- M&F bends generally used in 1 direction sweep bends or multi part bends

Contact

4 Aldinga Street, Brendale, Qld 4500  
 P.O Box 5066, Brendale QLD, 4500  
 ABN: 42 606 838 206  
 Ph: 1300 327 306

COMPLIES WITH AS/NZS 61386

1/05/2024



**BEST ENVIRONMENTAL PRACTICE**

